

# Installation Guide - CombiPump to GreaseShield®2000-PF

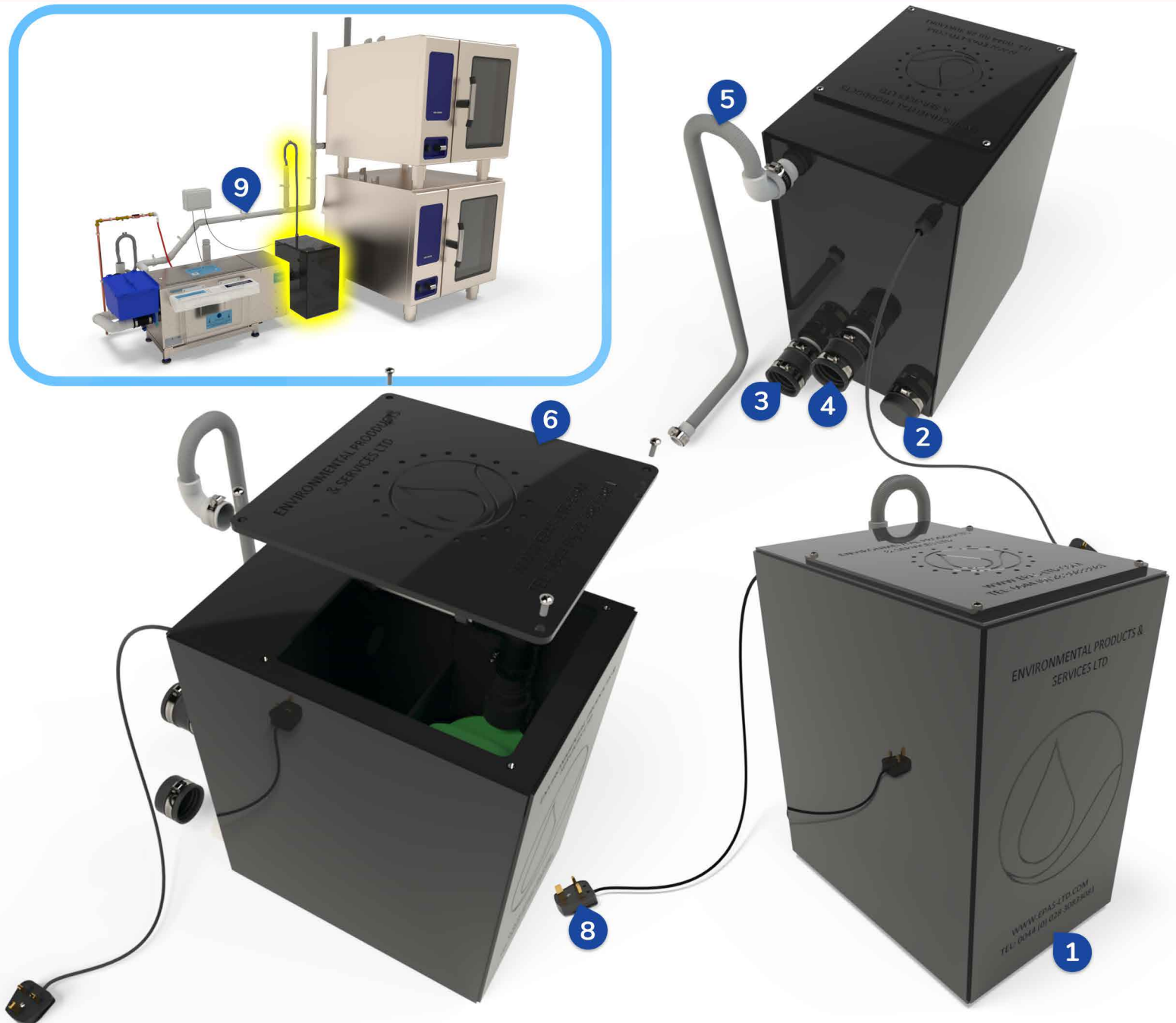

- 1 CombiPump Unit:** Ensure that there is sufficient clearance above the unit so the internal pump can be accessed and for servicing purposes.
- 2 Left Inlet Pipe – 2”/50mm:** To be piped with a sufficient fall of no less than 1 in 40. If not in use then it should be capped off using the 2”/50mm FlexiPlumb Endcap provided.
- 3 Right Inlet Pipe – 2”/50mm:** To be piped with a sufficient fall of no less than 1 in 40. If not in use then it should be capped off using the 2”/50mm FlexiPlumb Endcap provided.
- 4 Emergency Overflow Pipe – 2”/50mm:** To be piped with a sufficient fall of no less than 1 in 40.
- 5 Outlet Hose – ¾”/18mm:** To be piped into a vented drainage stack as shown, which leads to Inlet of a GreaseShield® unit. The Hose must be fixed in place using the drainage hose support provided.
- 6 CombiPump Lid:** The CombiPump Lid must be screwed in place during normal operation, and only removed for maintenance purposes.
- 7 Running Trap (Not Shown, see Page 3):** The Emergency Overflow of unit must be fitted with a running trap to reduce foul smells.
- 8 Power Lead:** The unit must be plugged into a **13 amp** rated IP56 socket located below counter level.
- 9 Interconnecting Pipework:** All pipework must be clipped and properly supported.

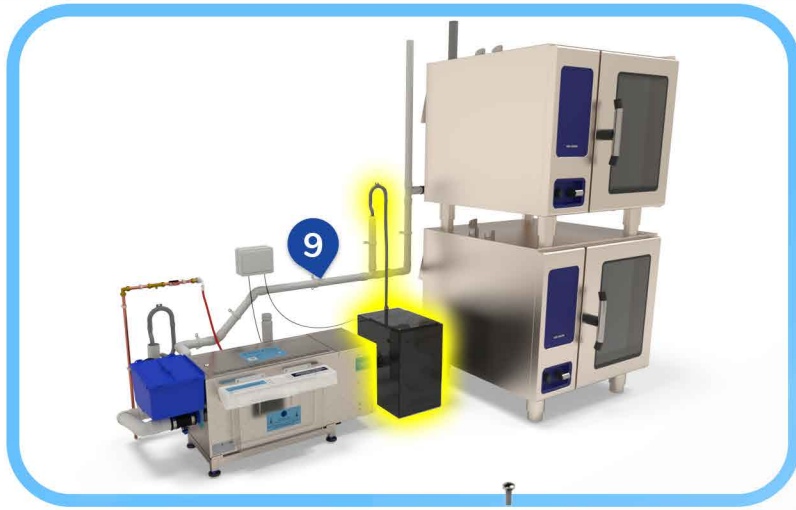

**Environmental  
Products and Services Ltd**

Award Winning Technology

V1 23/12/2021

[www.GreaseShield.com](http://www.GreaseShield.com)

HEAD OFFICE +44 (0) 28 3083 3081

[sales@epas-ltd.com](mailto:sales@epas-ltd.com)

GB OFFICE +44 (0) 161 477 5555

# Installation Guide - CombiPump to GreaseShield®2000-PF

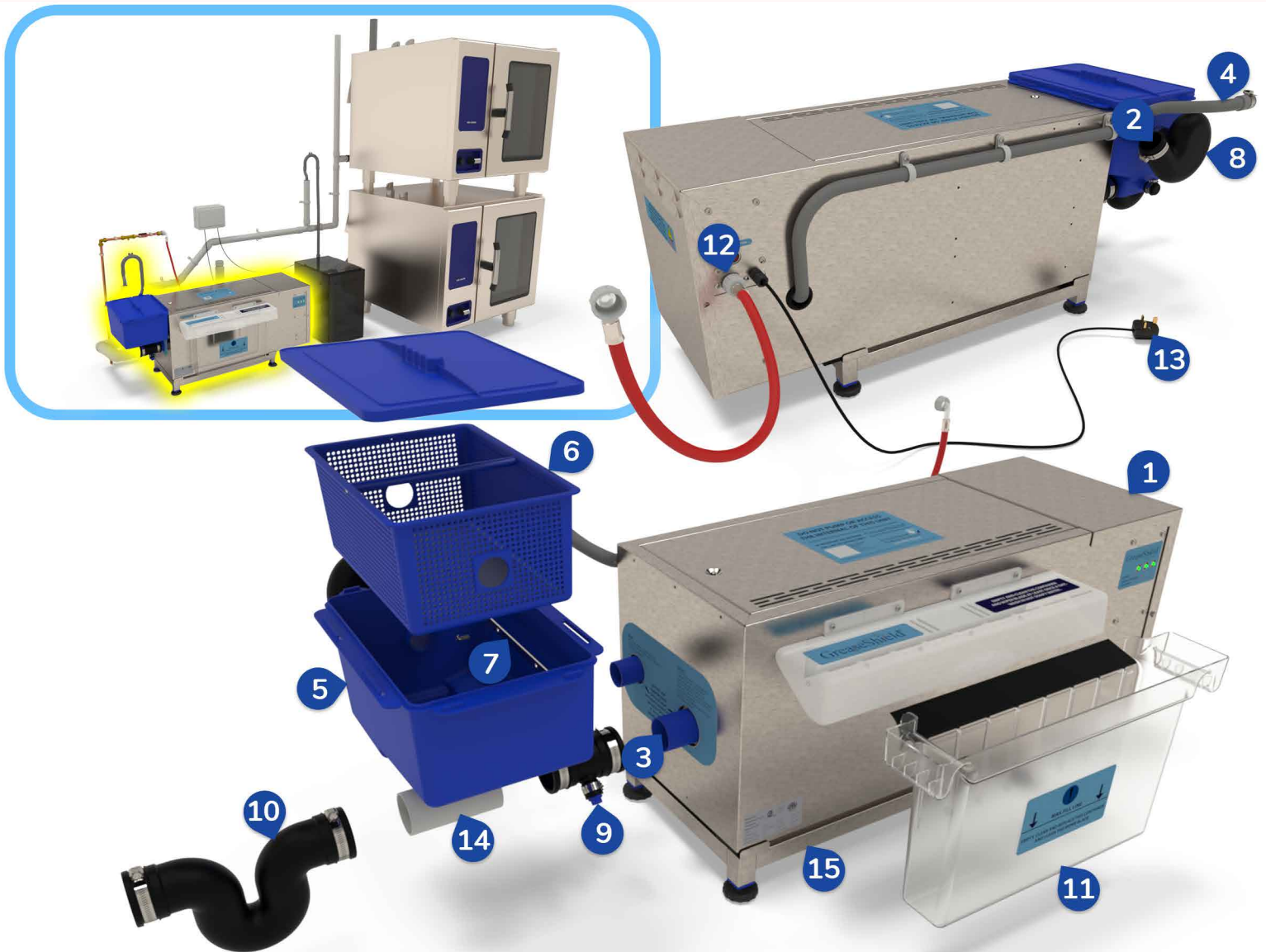

- 1 **GS2000 Unit:** Ensure that there is sufficient clearance above and to the right of the unit for servicing purposes (5.9"/150mm minimum).
- 2 **Inlet Pipe – 1½"/40mm:** To be piped with a sufficient fall of no less than 1 in 40.
- 3 **Outlet Pipe – 2"/54mm:** To be piped with a sufficient fall of no less than 1 in 40.
- 4 **Decant Outlet Hose – ¾"/18mm:** To be piped directly into the main drainage pipe via a vented drainage stack as shown. The Hose must be fixed in place using the the drainage hose support provided.
- 5 **Pre-Filter:** Ensure sufficient height above the Pre-Filter to allow for removal and daily maintenance of Pre-Filter basket.
- 6 **Pre-Filter Basket:** A Pre-Filter basket must be installed into the pre-filter at all times.
- 7 **Pre-Filter Support Bar:** The support bar must be installed when attaching the Pre-Filter
- 8 **Vortex Flow Controller:** Must be fitted to the Pre-Filter inlet connection.
- 9 **Sampling Point:** Connected to the outlet of the unit: it is essential in the analysis of effluent leaving the unit.
- 10 **Running Trap:** The outlet of unit must be fitted with a running trap to reduce foul smells.
- 11 **FOG Container:** Ensure that the container is not restricted or blocked for daily maintenance.
- 12 **Hot Water Solenoid Valve:** Hot water must be connected to the unit using the ¾" BSP (F/F) Red PVC Hose provided, water supply must not exceed **3 bar** pressure and **60°C/140°F**. In the case of high pressure a pressure reducing valve must be used. Mains water connections must be made via a WRAS approved isolation valve which follows a WRAS approved double check valve.
- 13 **Power Lead:** The unit must be plugged into a **13 amp** rated **IP56** socket located below counter level.
- 14 **Interconnecting Pipework:** All pipework must be clipped and properly supported.
- 15 **Stainless Steel Hygiene Stand (Optional Extra):** GS2000 unit should be installed on a Stainless Steel Hygiene stand. It can be adjusted up to **2"/50mm** in height to allow the unit to be levelled on uneven surfaces and provide access for cleaning.



**Environmental  
Products and Services Ltd**

Award Winning Technology

V1 23/12/2021

[www.GreaseShield.com](http://www.GreaseShield.com)

HEAD OFFICE +44 (0) 28 3083 3081

[sales@epas-ltd.com](mailto:sales@epas-ltd.com)

GB OFFICE +44 (0) 161 477 5555



# Installation Guide - CombiPump to GreaseShield®2000-PF

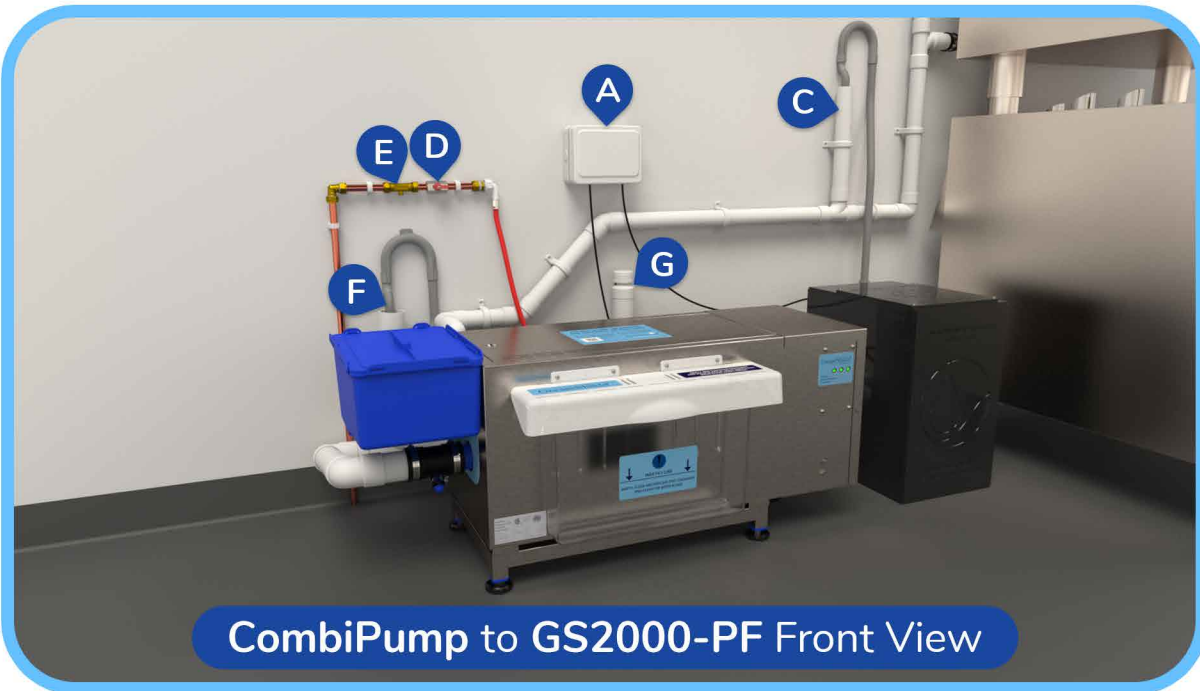

CombiPump to GS2000-PF Front View



CombiPump to GS2000-PF Rear View

- Make sure the CombiPump and GreaseShield® are installed on level ground or adjust the feet on the hygiene stand to ensure the GreaseShield® is level.
- Have an IP56 rated double socket **A** below counter level available for the CombiPump and GreaseShield to plug into. If a genie H2O is required ensure an additional power supply (preferably a fuse spur) is available.
- Ensure all pipe work into and out of the unit has at least a 1 in 40 fall (downwards angle of 1.5°).
- When installing the CombiPump on an oven, a tundish, or alternate air break **B** or vent must be fitted on the inlet pipework, after the ovens outlet. Consult the oven manufacturers installation instructions for guidance.
- The CombiPump Outlet Hose **C** needs to be plumbed into a vented drainage stack, using the drain hose support provided.
- Make sure there is enough space above the CombiPump to access the internal pump for servicing.
- Make sure the Lid of the CombiPump is securely screwed in place during normal operation.
- Connect the Emergency Overflow to the main waste water drain, with a running trap to prevent foul smells.
- Have a hot water connection available to connect to the GreaseShield®, if one is not available the unit must be equipped with a Genie H2O to give hot water on demand. Water connection must be made via a WRAS approved isolation valve **D** and double check valve **E**.
- The Decant Outlet Hose **F** needs to be plumbed into a vented drainage stack, using the drain hose support provided.
- Clean the Pre-Filter basket and FOG container daily.
- An Air Admittance Valve **G** must be installed after any running traps so a siphon doesn't occur.
- Place either unit in passageways where it can be a hazard or be damaged.
- Open either unit or insert hands into any part of the units; moving parts can cause injury.
- Stand or place heavy objects on top of either unit.
- Dismantle either unit in any way, only qualified service staff are to access the inside of the units.



DO



DON'T



Environmental  
Products and Services Ltd

Award Winning Technology

V1 23/12/2021

[www.GreaseShield.com](http://www.GreaseShield.com)

HEAD OFFICE +44 (0) 28 3083 3081

[sales@epas-ltd.com](mailto:sales@epas-ltd.com)

GB OFFICE +44 (0) 161 477 5555